

## 1Ø, 250Vac (150/200A) : 단상 교류 250V 고감쇠형 BSH-2\*\*\*-MS Series (High Atten. type)



### ■ Features

- High performance
- Multi stage
- Small size
- Low cost
- Dual PE system

### ■ Typical Applications

- General purpose
- Industrial equipment
- Motor drive equipments
- AVR, UPS, Inverter, Converter
- Factory automation equipment
- Single-phase electricity supply
- ACB Panel, distribution Panel

### ■ Technical specifications

Items	BSH-2150-MS	BSH-2200-MS
Rated Voltage (V <sub>R</sub> )	1Ø, 250Vac	
Operating frequency	50 / 60Hz	
Rated Currents @40°C (I <sub>R</sub> )	150A	200A
Withstanding voltage test	Line to Earth : 2,121Vdc for 1min. or 2,750Vdc for 2sec. ( BHSTD-QUA-Q201 )	
Insulation resistance	500Vdc for 1min. 300MΩ Min. ( BHSTD-QUA-Q202 )	
Voltage drop	1.0V Max. ( BHSTD-QUA-Q204 )	
Temperature range	25/100/21 (-25°C to +100°C), 20~95% RH at Operating & Storage	
Designed according to	IEC/EN 60939 / UL1283 / CSA 22.2 No.8	

### ■ Derating Curve

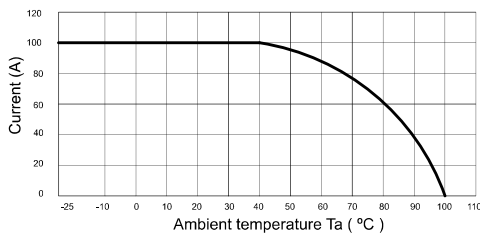

### ■ Shape & Dimension (mm)

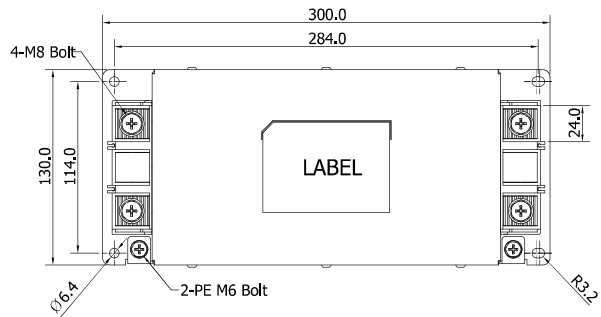

### ■ Lug ring terminal

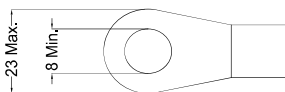

### ■ Recommended torque

8.9 ~ 10.8 N · m

